

For Sale/Lease

35 Davis Road WETHERILL PARK

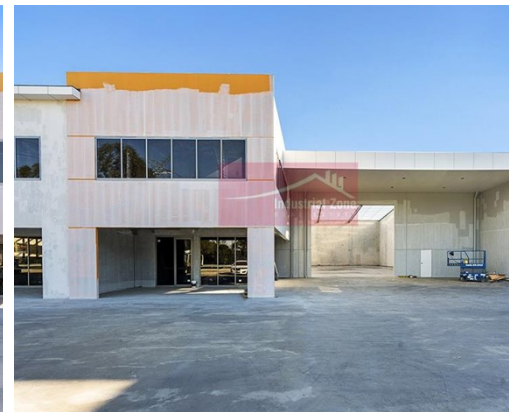

BRAND NEW - UNDER CONSTRUCTION

Unit	Office m ²	Warehouse m ²	Total Area m ²	Parking	Rent	Price
Unit 1	276	1,270	1,546	20		\$5,180,000 + GST
Unit 2	174	1,040	1,214	17		\$4,065,000 + GST
Unit 3	174	1,040	1,214	0	\$169,950 Pa Net + GST	
Unit 4	174	1,040	1,214	0	\$182,091 Pa Net + GST	
Unit 5	174	1,040	1,214	17	\$182,091 Pa Net + GST	\$4,248,790 + GST
Unit 6	174	1,040	1,214	17		\$4,127,396 + GST

Description

- * Modern industrial warehouses currently under construction
- * Units available for sale ranging from 1,214m² up to 2,760m²
- * Units available For lease ranging from 1,214m² to 3,642m²
- * A grade building with full concrete height panel construction
- * Clear span warehouse with 8m + of internal clearance
- * Fully appointed ground and first floor offices with ducted a/c, carpet and amenities on both levels
- * Each unit with fenced yard area for storage/loading area
- * Date of completion 1st June 2019

All dimensions and figures are approximate.

Unless stated, all prices quoted are exclusive of GST.

Zoning

IN1 General Industrial

For more information please contact



Burak Turkmener
0431 561 996
burak@industrialzone.com.au