

6 Schofield Street Riverwood

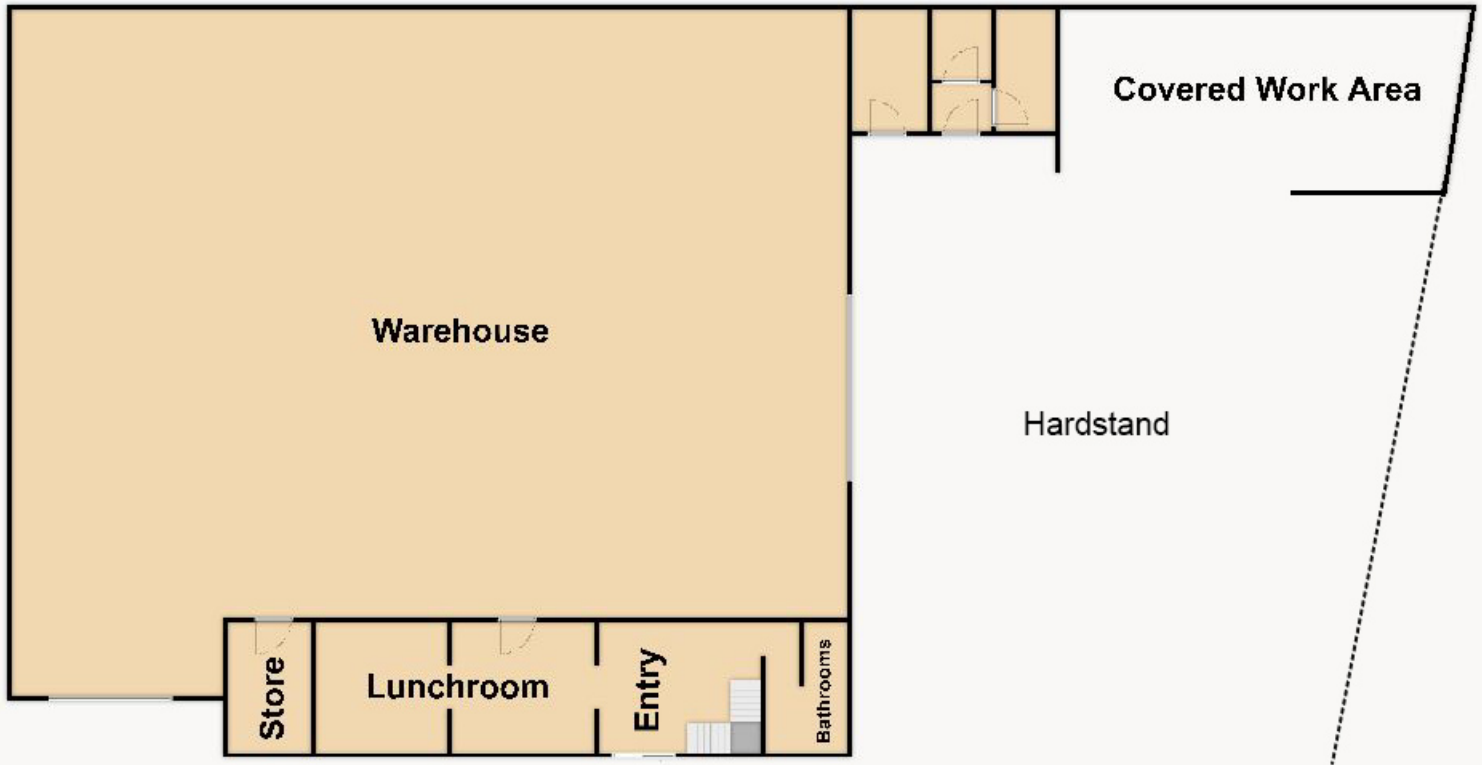

Ground Floor 670m²
First Floor 115m²
Mezzanine 60m²
Rear Amenities inc
Covered work area 200m²

Land 1,135m²



Disclaimer: This floor plan has been provided as a guide only and is not drawn to scale.
IZRE cannot guarantee its accuracy and all interested parties should rely on their own enquiries.